

**INDEX OF DOCUMENTS HELD ON THE PETROLEUM REGISTER FOR  
ASSOCIATED ACTIVITIES LICENCE AAL 221**

---

1. 17 November 2014 Grant of Associated Activities Licence AAL 221.  
  
Interests in the licence are:-  
  
Stuart Petroleum Pty Ltd 100%
2. 17 November 2014 Memorandum entering grant of licence on the public register.
3. 20 November 2014 Gazettal of grant of licence.

## PETROLEUM AND GEOTHERMAL ENERGY ACT 2000

*Grant of Associated Activities Licence—AAL 221**(Adjunct to Petroleum Exploration Licence PEL 637)*

NOTICE is hereby given that the undermentioned Associated Activities Licence has been granted with effect from 17 November 2014, under the provisions of the Petroleum and Geothermal Energy Act 2000, pursuant to delegated powers dated 21 March 2012.

No. of Licence	Licensee	Date of Expiry	Locality	Reference
AAL 221	Stuart Petroleum Pty Ltd	16 November 2015	Cooper Basin	F2014/001068

*Description of Area*

All that part of the State of South Australia, bounded as follows:

Commencing at a point being the intersection of latitude 28°22'50"S AGD66 and longitude 140°16'40"E GDA94, thence east to longitude 140°17'05"E GDA94, south to latitude 28°23'00"S AGD66, east to longitude 140°17'30"E AGD66, south to latitude 28°23'10"S GDA94, west to longitude 140°17'20"E GDA94, south to latitude 28°23'40"S AGD66, west to longitude 140°16'30"E AGD66, north to latitude 28°23'10"S AGD66, east to longitude 140°16'40"E GDA94 and north to the point of commencement.

Area: 1.87 km<sup>2</sup> approximately.

Dated 17 November 2014.

B. A. GOLDSTEIN,  
Executive Director,  
Energy Resources Division,  
Department of State Development  
Delegate of the Minister for Mineral Resources and Energy

## PETROLEUM AND GEOTHERMAL ENERGY ACT 2000

*Grant of Gas Storage Exploration Licence—GSEL 648*

NOTICE is hereby given that the undermentioned Gas Storage Exploration Licence has been granted under the provisions of the Petroleum and Geothermal Energy Act 2000.

No. of Licence	Licensee	Locality	Date of Expiry
GSEL 648	Beach Energy Limited Great Artesian Oil and Gas Pty Ltd	Cooper Basin	13 November 2019

*Description of Area*

All that part of the State of South Australia, bounded as follows:

Commencing at a point being the intersection of latitude 27°35'00"S AGD66 and longitude 139°30'00"E AGD66, thence east to longitude 139°35'00"E AGD66, south to latitude 27°40'00"S AGD66, east to longitude 139°40'00"E AGD66, south to latitude 27°56'25"S GDA94, west to longitude 139°39'20"E GDA94, south to latitude 27°57'00"S GDA94, west to longitude 139°39'15"E GDA94, south to latitude 27°57'25"S GDA94, west to longitude 139°39'05"E GDA94, south to latitude 27°57'45"S GDA94, west to longitude 139°38'45"E GDA94, south to latitude 27°58'25"S GDA94, east to longitude 139°39'50"E GDA94, south to latitude 27°58'40"S GDA94, east to longitude 139°40'00"E AGD66, south to latitude 28°00'00"S AGD66, west to longitude 139°35'00"E AGD66, north to latitude 27°55'00"S AGD66, west to longitude 139°30'00"E AGD66, north to latitude 27°50'00"S AGD66, west to longitude 139°20'00"E AGD66, north to latitude 27°40'00"S AGD66, west to longitude 139°15'00"E AGD66, north to latitude 27°35'00"S AGD66, west to longitude 139°09'30"E GDA94, north to latitude 27°32'30"S GDA94, east to longitude 139°10'30"E GDA94, north to latitude 27°31'00"S GDA94, east to longitude 139°11'00"E GDA94, north to latitude 27°30'00"S GDA94, east to longitude 139°12'00"E GDA94, north to latitude 27°29'30"S GDA94, east to longitude 139°13'00"E GDA94, north to latitude 27°28'30"S GDA94, east to longitude 139°13'30"E GDA94, north to latitude 27°27'30"S GDA94, east to longitude 139°15'00"E GDA94, north to latitude 27°26'30"S GDA94, east to longitude 139°16'30"E GDA94, north to latitude 27°25'30"S GDA94, east to longitude 139°17'30"E GDA94, north to latitude 27°24'30"S GDA94, east to longitude 139°18'00"E GDA94, north to latitude 27°22'30"S GDA94, east to longitude 139°19'00"E GDA94, north to latitude 27°20'00"S GDA94, east to longitude 139°21'30"E GDA94, north to latitude 27°17'00"S GDA94, east to longitude 139°23'00"E GDA94, north to latitude 27°15'00"S AGD66, east to longitude 139°30'00"E AGD66 and south to the point of commencement.

Area: 1966.15 km<sup>2</sup> approximately.

Dated 14 November 2014.

B. A. GOLDSTEIN,  
Executive Director,  
Energy Resources Division,  
Department of State Development  
Delegate of the Minister for Mineral Resources and Energy

**Petroleum and Geothermal Energy Act 2000**  
**S.115**

**MEMORANDUM**

**ASSOCIATED ACTIVITIES LICENCE**  
**AAL 221**

1. This Licence granted on 17 November 2014 is hereby entered on the public register.
2. Interests in the licence are:-

Stuart Petroleum Pty Ltd	100%
--------------------------	------



**BARRY A. GOLDSTEIN**  
**Executive Director**  
**Energy Resources Division**  
**Department of State Development**  
**Delegate of the Minister for Mineral Resources and Energy**

Date: 17 November 2014

File: F2014/001068

# ***Petroleum and Geothermal Energy Act 2000***

## **ASSOCIATED ACTIVITIES LICENCE**

### **AAL 221**

I, BARRY ALAN GOLDSTEIN, Executive Director, Energy Resources Division, Department of State Development, in the State of South Australia, pursuant to the provisions of the *Petroleum and Geothermal Energy Act 2000* and all other enabling powers, for and on behalf of Tom Koutsantonis, Minister for Mineral Resources and Energy (Minister), pursuant to delegated powers dated 21 March 2012, HEREBY GRANT to:

**Stuart Petroleum Pty Ltd**  
ACN 059 146 226

(hereinafter referred to as the Licensee) an Associated Activities Licence as an adjunct to Petroleum Exploration Licence PEL 637 in respect of the area set out below, to have effect from *17 November 2014* and to expire on *16 November 2015* and carrying the right of renewal subject to the provisions of the *Petroleum and Geothermal Energy Act 2000*.

### **DESCRIPTION OF AREA**

*BAG*  
*17/11/14*

The land comprised in this licence is that part of the State of South Australia described in the Schedule hereto.

### **CONDITIONS**

1. During the term of the licence, the Licensee may carry out or cause to be carried out the Bauhaus 3D Seismic Survey within the area as defined in the Schedule hereto.
2. Pursuant to Section 74 of the Act the regulated activities to be carried out pursuant to this Licence are classified as requiring low level official surveillance.
3. The Licensee must:
  - (a) upon commencement of regulated activities under this licence, maintain in force during the term of this licence public liability insurance to cover regulated activities under this licence (including sudden and accidental pollution) in the name of the Licensee for a sum not less than twenty million dollars (\$20,000,000.00) or such greater sum as specified by the Minister, and make such amendments to the terms and conditions of the insurance as the Minister may from time to time require;
  - (b) upon request by the Minister, provide the Minister with a cover note or certificate of currency of the insurance policy referred to in paragraph (a).
4. The Minister in specifying the levels of insurance accepts no liability for the completeness of their listing, the adequacy of the sum insured, the limit of liability, the scoped coverage, or the conditions or exclusions of these insurances in respect to how they may or may not respond to any loss, damage or liability.

Date: 17 November 2014



.....  
**BARRY A. GOLDSTEIN**  
**Executive Director**  
**Energy Resources Division**  
**Department of State Development**  
**Delegate of the Minister for Mineral Resources and Energy**

**EXECUTED BY THE LICENSEE:**

**EXECUTED** by Stuart Petroleum Pty Ltd (ACN 059 146 226)  
in accordance with Section 127 of the  
*Corporations Act 2001 (Cth)*:



.....  
Signature of Director

IAN RICHARD DAVIES

.....  
[Print Name of Director]

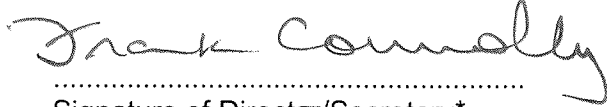

.....  
Signature of ~~Director~~/Secretary\*

FRANCIS LEO CONNOLLY

.....  
[Print Name of ~~Director~~/Secretary\*]

(\*delete the inapplicable)

**THE SCHEDULE**  
**ASSOCIATED ACTIVITIES LICENCE**  
**AAL 221**

**Description of Area**

All that part of the State of South Australia, bounded as follows:-

Commencing at a point being the intersection of latitude 28°22'50"S AGD66 and longitude 140°16'40"E GDA94, thence east to longitude 140°17'05"E GDA94, south to latitude 28°23'00"S AGD66, east to longitude 140°17'30"E AGD66, south to latitude 28°23'10"S GDA94, west to longitude 140°17'20"E GDA94, south to latitude 28°23'40"S AGD66, west to longitude 140°16'30"E AGD66, north to latitude 28°23'10"S AGD66, east to longitude 140°16'40"E GDA94, and north to the point of commencement.

AREA: **1.87** square kilometres approximately.

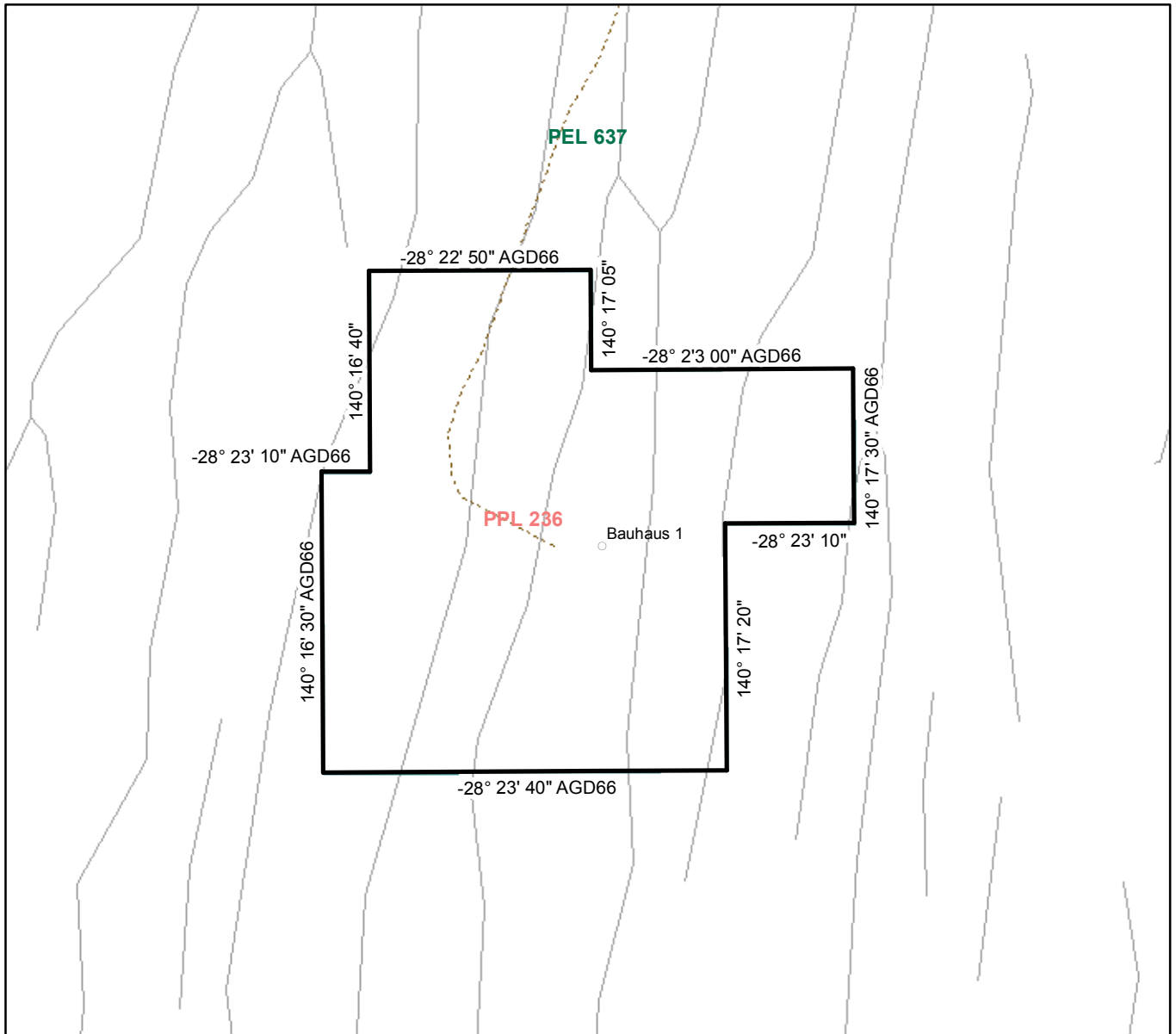

SCALE 1: 20 000



Note: There is no warranty that the boundary of this licence is correct in relation to other features of the map. The boundary is to be ascertained by reference to the Australian Geodetic Datum (AGD66), the Geocentric Datum of Australia (GDA94) and the schedule.

THE PLAN HEREINBEFORE REFERRED TO  
**ASSOCIATED ACTIVITIES LICENCE NO: 221**