

PETROLEUM AND GEOTHERMAL ENERGY ACT 2000

*Grant of Associated Activities Licence—AAL 203
(Adjunct to Petroleum Exploration Licence PEL 516)*

NOTICE is hereby given that the undermentioned Associated Activities Licence has been granted with effect from 14 April 2014, under the provisions of the Petroleum and Geothermal Energy Act 2000, pursuant to delegated powers dated 21 March 2012.

No. of Licence	Licensee	Locality	Reference
AAL 203	Stuart Petroleum Pty Ltd	Cooper Basin	F2014/000027

Description of Area

All that part of the State of South Australia, bounded as follows:

Commencing at a point being the intersection of latitude 28°40'00"S AGD66 and the western boundary of National Native Title Tribunal Claimant Application File No. SC98/01 (Registered 8/01/1998), thence east to longitude 139°56'45"E GDA94, south to latitude 28°40'20"S GDA94, west to the western boundary of National Native Title Tribunal Claimant Application File No. SC98/01 (Registered 8/01/1998) and generally north-easterly along the boundary of the said Claimant Application to the point of commencement.

Area: 5.21 km² approximately.

Dated 14 April 2014.

B. A. GOLDSTEIN,
Executive Director,
Energy Resources Division,
Department for Manufacturing, Innovation, Trade, Resources and Energy
Delegate of the Minister for Mineral Resources and Energy

Petroleum and Geothermal Energy Act 2000
S.115

MEMORANDUM

ASSOCIATED ACTIVITIES LICENCE
AAL 203

1. This Licence granted on 14 April 2014 is hereby entered on the public register.

2. Interests in the licence are:-

Stuart Petroleum Pty Ltd

100%



BARRY A. GOLDSTEIN

Executive Director

Energy Resources Division

Department for Manufacturing, Innovation, Trade, Resources and Energy

Delegate of the Minister for Mineral Resources and Energy

Date: 14 April 2014

File: F2014/000027

Petroleum and Geothermal Energy Act 2000

ASSOCIATED ACTIVITIES LICENCE

AAL 203

I, BARRY ALAN GOLDSTEIN, Executive Director, Energy Resources Division, Department for Manufacturing, Innovation, Trade, Resources and Energy, in the State of South Australia, pursuant to the provisions of the *Petroleum and Geothermal Energy Act 2000* and all other enabling powers, for and on behalf of Tom Koutsantonis, Minister for Mineral Resources and Energy (Minister), pursuant to delegated powers dated 21 March 2012, HEREBY GRANT to:

Stuart Petroleum Pty Ltd
ACN 059 146 226

(hereinafter referred to as the Licensee) an Associated Activities Licence as an adjunct to Petroleum Exploration Licence PEL 516 in respect of the area set out below, to have effect for a period of one year and to expire on *13 April 2015* and carrying the right of renewal subject to the provisions of the *Petroleum and Geothermal Energy Act 2000*.

DESCRIPTION OF AREA

BAG
14/4/14

The land comprised in this licence is that part of the State of South Australia described in the Schedule hereto.

CONDITIONS

1. During the term of the licence, the Licensee may carry out or cause to be carried out, the Padulla 3D seismic survey within the area as defined in the Schedule hereto.
2. Pursuant to Section 74 of the Act all regulated activities authorised by this licence are classified as requiring high level official surveillance, unless the Licensee satisfies the Minister that, in view of the Licensee's demonstrated competence to comply with the requirements of the Act and the conditions of this Licence, the activities should be classified as requiring low level official surveillance.
 - 2.1 The Minister's prior written approval is required for activities requiring high level official surveillance in accordance with the Regulation 19 of the Regulations to the Act.
3. The Licensee must:
 - (a) upon commencement of regulated activities under this licence, maintain in force during the term of this licence public liability insurance to cover regulated activities under this licence (including sudden and accidental pollution) in the name of the Licensee for a sum not less than twenty million dollars (\$20,000,000.00) or such greater sum as specified by the Minister, and make such amendments to the terms and conditions of the insurance as the Minister may from time to time require;
 - (b) upon request by the Minister, provide the Minister with a cover note or certificate of currency of the insurance policy referred to in paragraph (a).

4. The Minister in specifying the levels of insurance accepts no liability for the completeness of their listing, the adequacy of the sum insured, the limit of liability, the scoped coverage, or the conditions or exclusions of these insurances in respect to how they may or may not respond to any loss, damage or liability.

Date:..... 14 April 2014



.....
BARRY A. GOLDSTEIN
Executive Director
Energy Resources Division
Department for Manufacturing, Innovation, Trade, Resources and Energy
Delegate of the Minister for Mineral Resources and Energy

EXECUTED BY THE LICENSEE:

EXECUTED by Stuart Petroleum Pty Ltd (ACN 059 146 226)

in accordance with Section 127 of the

Corporations Act 2001



.....

Signature of Director

IAN RICHARD DAVIES

.....

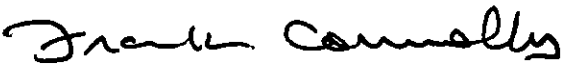
[Print Name of Director]

.....

Signature of ~~Director~~/Secretary*

FRANCIS LEO CONNOLLY

.....

[Print Name of ~~Director~~/Secretary*]

(*delete the inapplicable)

THE SCHEDULE
ASSOCIATED ACTIVITIES LICENCE

AAL 203

Description of Area

All that part of the State of South Australia, bounded as follows:

Commencing at a point being the intersection of latitude 28°40'00" S AGD66 and the western boundary of National Native Title Tribunal Claimant Application File Number SC98/01 (Registered 8/01/1998), thence east to longitude 139°56'45" E GDA94, south to latitude 28°40'20" S GDA94, west to the western boundary of National Native Title Tribunal Claimant Application File Number SC98/01 (Registered 8/01/1998) and generally north-easterly along the boundary of the said Claimant application to the point of commencement.

AREA: **5.21** square kilometres approximately

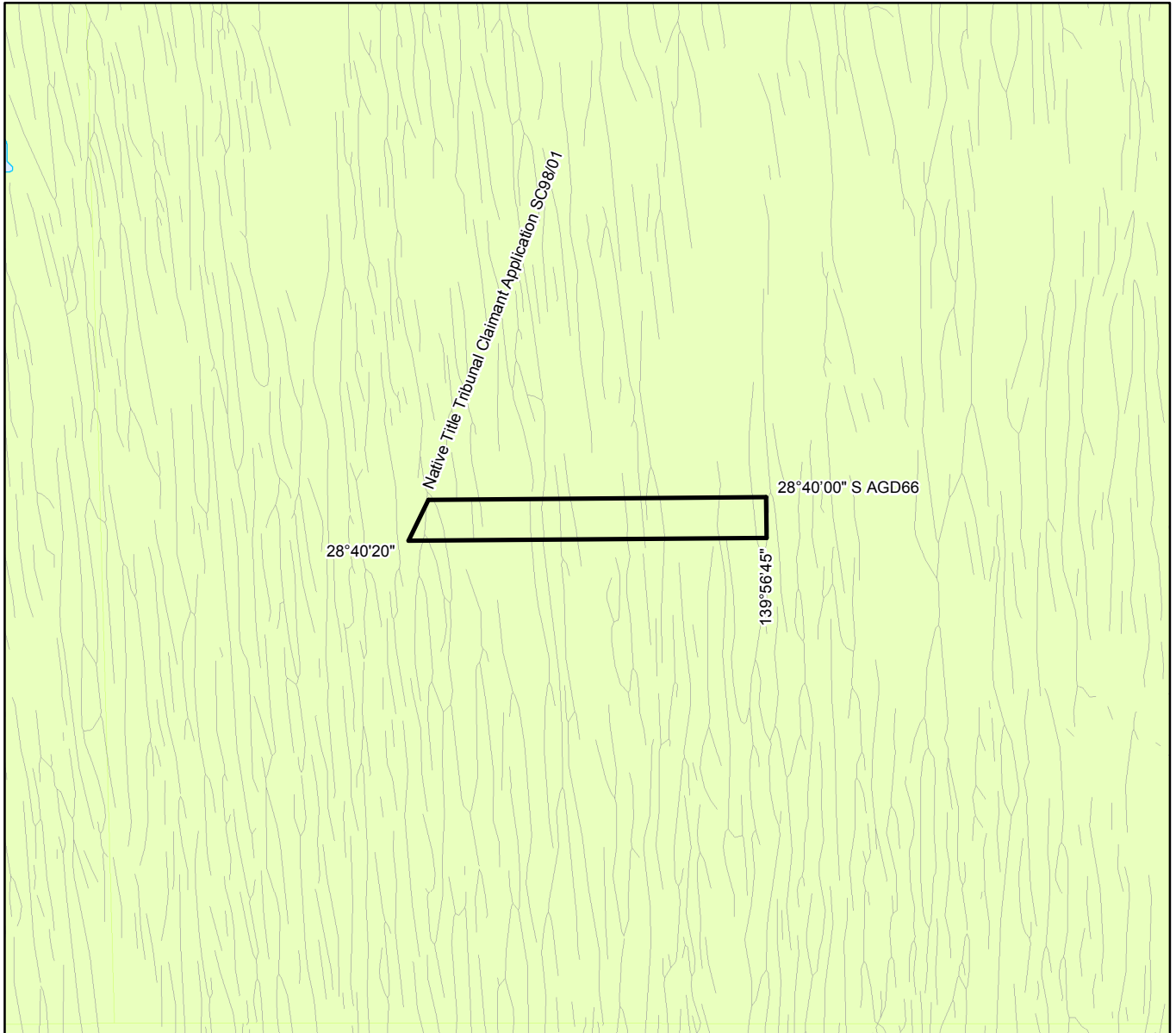

SCALE 1: 125 000

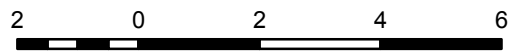

Kilometres

Note: There is no warranty that the boundary of this licence is correct in relation to other features of the map. The boundary is to be ascertained by reference to the Geocentric Datum of Australia (GDA94) and the schedule.

THE PLAN HEREINBEFORE REFERRED TO

ASSOCIATED ACTIVITIES LICENCE NO: 203

